

1.15// PRESSURE SWITCH FM APPROVED (SKYEG-PSW)



FEATURES

Service Environment: Indoor or Outdoor Use, all parts have corrosion resistant finishes

Temperature Range: 0°C- 80°C

Cover Tamper: Tamper Resistant Screws Optional Cover Tamper Switch Available

Connection: 1/2-14NPT Thread

Electrical Ratings: 125/250VAC 15A

Different pressure springs are selected according to the difference between the power range of the Pressure Switch (5-20 psi, 15-55 psi, 20-120 psi).

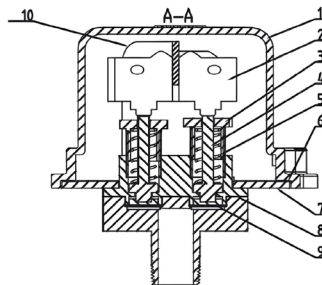
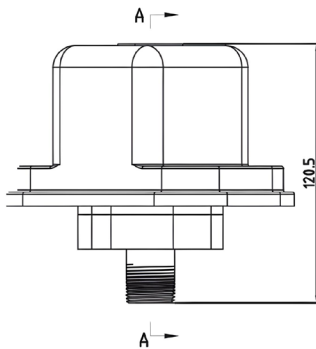

MATERIAL SPECIFICATIONS

|| = Other Options

No.	Part Name	Material	No.	Part Name	Material
1	Outer Shell	ADC12	6	Sealing Washer	PA66+GF30
2	Micro Switch		7	Back Shell	ADC12
3	Regulating Accessories	PA66+GF30	8	Pressure parts	PA66+GF30
4	Stem	PA66+GF30	9	Pressure Diaphragm	EPDM
5	Compression Spring	65#	10	Micro Stents	CS Q235 AISI 304

Note: For special material request other than standard specification, please indicate clearly on the inquiry or order list.



TYPICAL ELECTRICAL CONNECTIONS

